

September 2009



Aquarius Instruction Manual



September 2009

## Contents

General section

<b>A. Introduction</b>	The company The principles The execution	A.1 A.1 A.1
<b>B. The product</b>	Overview Features Safety	B.2 B.2 B.3
<b>C. Installation</b>	Placement Equipment coupling System integration	C.4 C.4 C.4
<b>D. Troubleshooting</b>	Fault finding	D.5
<b>E. Specifications</b>	Dimensions & sockets	E.6
<b>F. Considerations</b>	Cabling Third party products Upgrades	F.8 F.8 F.8
<b>G. Warranty</b>		G.9



## The company



## A. Introduction

### The company

IsoTek was formed in July 2001 with the vision to create high quality mains power distribution units that moved beyond current conventions. Through careful market analysis and extensive research we were able to launch products that moved power distribution forward to be recognised as an integral part of any audio or home theatre system. Our products continue to lead the way in power management systems, our latest EVO3 range galvanises our commitment to pursue excellence at every level.

### The principles

We believe all products benefit from their own clean power supply, therefore we advocated the concept of using (smaller) individual filters on each component, with these being specifically designed for their purpose, this dramatically reduces and stops component cross contamination and dispels the belief that one size fits all. Every single component used in our designs is extensively tested for quality, reliability and purpose. Our circuit designs are extensively 'field' tested before coming to market so we can guarantee the widest compatibility with third party products.

### The execution

Within the market of premium audio it is vital to offer exceptional performance and value for money. Products must be made to the highest of standards, be reliable and attractive. A manufacturer must offer exceptional service, dealer training, support and undertake the very best in promotion design and literature. If all these elements are in place customers should experience excellence at every stage. Our continual quest is to meet these challenges.

All of our products are professionally designed, manufactured and hand built in the UK, with deep consideration given to both style, functionality, performance and value for money.

## B. The product

### Front elevation of the unit

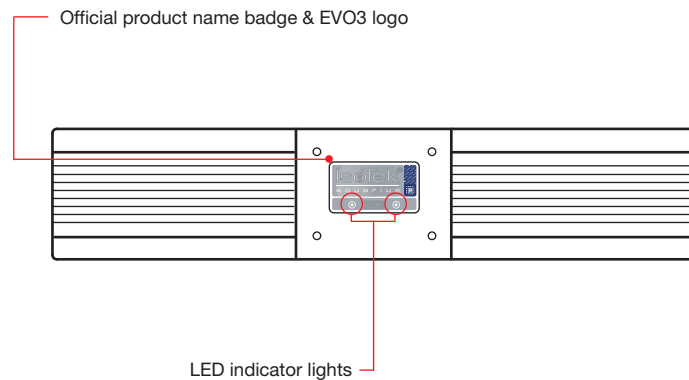

#### Overview

Thank you for purchasing the IsoTek Aquarius. The Aquarius continues our multi award winning range offering a complete system solution in a convenient single box. It was designed to be a very rewarding 'plug-n-play' solution for a complete audio or home theatre system. The Aquarius offers astounding value for money and gives a taste of what our truly high-end solutions offer. Within our product range the Aquarius sit between the Vision and Sigmas.

#### Features

At the rear of the unit you will note six high quality outlet, these are individually filtered to stop components 'talking' to each other or corrupting the clean supply provided by the unit.

Outputs 1 & 2 have been given a higher power rating and should be used for high current devices, for example power amplifiers, integrated amplifiers, some 'tube' pre-amplifiers, projectors and plasma screens etc. The remaining four are suitable for all other equipment.

Aquarius features 67,500 Amps of instantanious protection, this is extremely important in today's society where dangerous power surges can damage sensitive audio equipment.

All fusing is external, this eliminates any need to enter the product. The unit is so safe that even if the mains are wired incorrectly in the rest of the house or environment that the product is used, the unit will correct the problem sonically.

All components are of the highest grade and are under stressed, this gives greater longevity. These are hand soldered onto a PCB with silver solder, the large PCB also features a ground plane upper surface acting as a very high grade common mode filter across the whole board, this allows the unit to act as a true faraday cage, protecting itself from RFI and other components from the job it performs. The unit is also fully star earthed.

## B. The product

### Weight loading

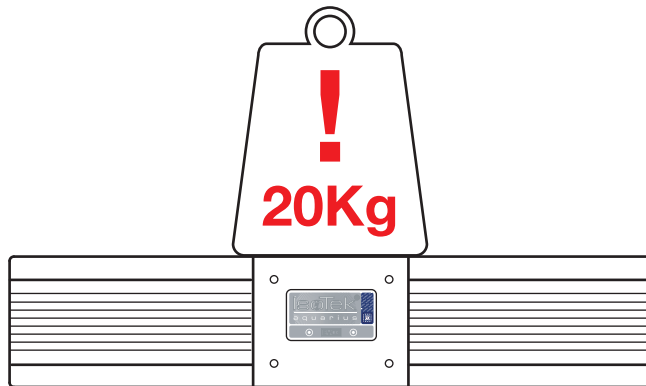

### Safety

In the interest of safety the unit should be placed upon its own dedicated shelf on an audio grade equipment rack. Ensure that a minimum distance of 50mm is allowed around the unit for sufficient ventilation. Ventilation should not be impeded by covering the ventilation openings with items such as newspapers, table-cloths, curtains etc. No naked flame sources, such as lighted candles should be placed on the unit.

The unit may be placed on top of or under other pieces of equipment, do not exceed a maximum weight loading of 20kg.

If you have to locate the unit on the floor we strongly recommend you do not place the unit near heat sources, such as radiators or air ducts. The unit should not be placed in areas which could exceed 25 degrees, for example near vacuum tube amplifiers. Good air circulation is essential to prevent heat build up within the chassis. Do not place the Aquarius on a soft surface, for example a rug or carpet, which could block the ventilation intakes on the underside of the unit.

Do not let any liquids spill onto or objects fall into the chassis.

**The apparatus must not be exposed to dripping or splashing and no objects filled with liquids, such as vases should not be placed on top.**

Should either of these events happen immediately switch off the unit at the wall socket, wait for at least one minute, unplug all other cables and return it to your authorised IsoTek dealer for a full service.

## C. Installation

### Equipment coupling

Once the Aquarius is placed, connect the unit to a mains wall socket. We recommend that a good quality cable is used and that the wall socket is also unswitched. The ideal cable to power the Aquarius would be the IsoTek Extreme, a true 20Amp cable fitted with a high quality 24ct deep cryogenically treated C19 IEC.

**The apparatus must be connected to an earthed mains socket-outlet.**

### System integration

Turn off all equipment you wish to have a clean mains supply, unplug the cables relating to these from the wall socket or redundant distribution block you may have been using, and plug these into the rear sockets of the Aquarius. The first two sockets, nearest to the C20 IEC in are high current, thermo magnetically fused at 16Amp. These should be used for your power amps, sub woofer, active loudspeakers or any device which draws high current. The remaining four outlets are suitable for all other equipment, for example pre-amps, CD players, DACs, tuner etc. You will notice on the back panel the VA and fusing is clearly stated. To get the best performance from Aquarius this technical advice must be followed.

We strongly recommend that each product connected to Aquarius is powered by a good quality mains cable and this cable is consistent throughout your system. IsoTek product a range of high quality cable at cost effective prices. If you already own dedicated Hi-Fi cables please insure that the cable has good conductors, for example oxygen free copper, this cable should also have a high degree of shielding from RFI and ideally feature 24ct gold connectors.

### Rear elevation of the unit

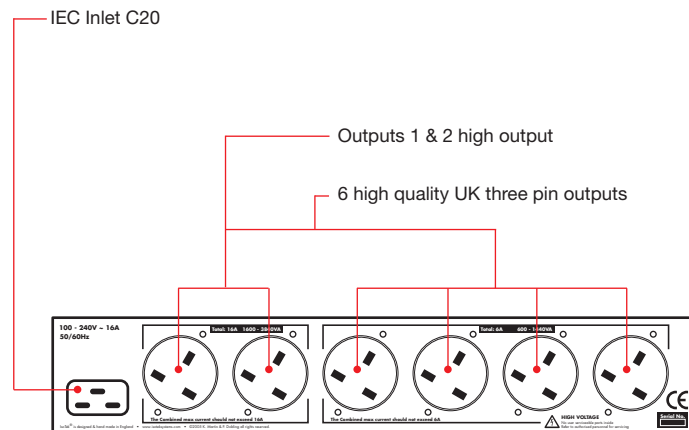

## D. Troubleshooting

### Fuse location

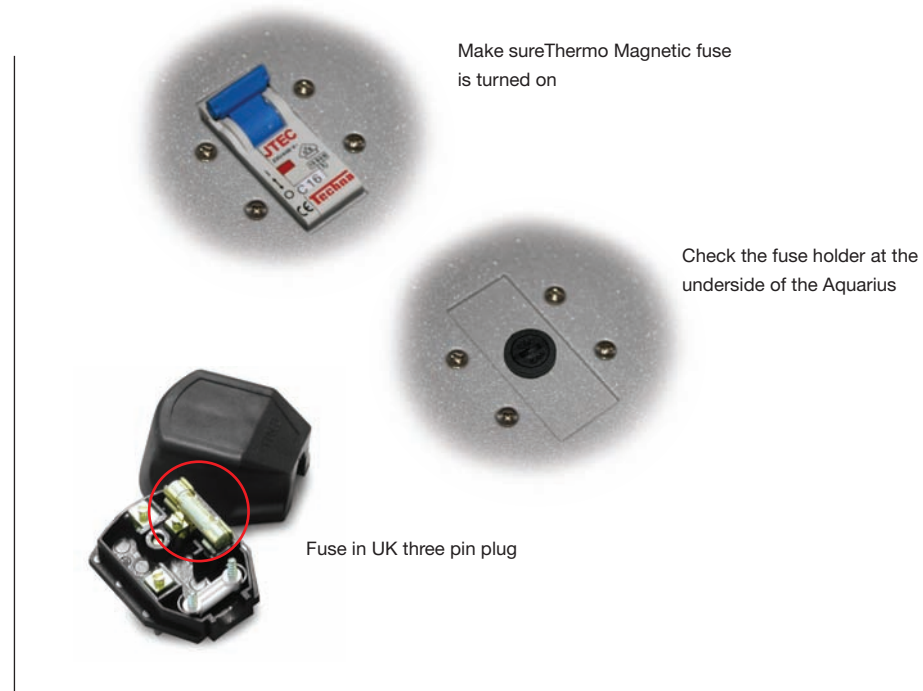

### Fault finding

The front panel LEDs are not lit and the unit gives no power.

Check that the Thermo Magnetic fuse on the underside of Aquarius is turned on. Check that the 5Amp fuse also located on the underside of the unit is intact. If the fuse requires replacement use class B fusing at a 5Amp rating or contact IsoTek by email [support@isoteksystems.com](mailto:support@isoteksystems.com) so that we can forward you a free replacement.

Check that the mains cable is securely plugged into the unit and the wall socket.

Check the fuse within the plug is intact.

On rare occasions the fuse at the main distribution fuse box may also need to be checked.

We would strongly recommend a simple check of mains polarity. Your local IsoTek authorised dealer will be able to supply a product through us to help you establish this. Mains polarity is of particular importance in markets where European Shuko plugs are used.

**Always replace fuses with the same fuse type and rating.**

Please contact us by email [support@isoteksystems.com](mailto:support@isoteksystems.com) if you are in any doubt about the correct fusing.

E. Specifications

Front & rear elevation

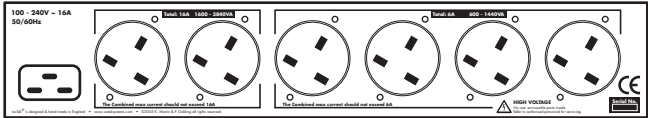
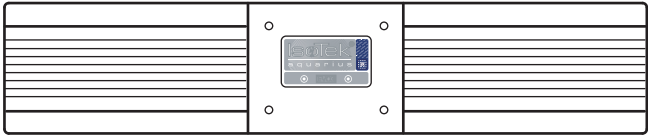

Dimensions  
& sockets

The following information relates only to the IsoTek Aquarius.

Number of outlets: 6  
Type of outlets: UK, EU, and US unswitched  
Mains inlet: 16Amp IEC C20

Mains voltage: 100 - 240V  
High current outlets (two nearest IEC): 16Amps  
Medium current (four outlets): 5Amps  
Maximum current: 16Amps continuous  
Total available power (230V): 3680W  
Transient Power: 18400W

Dimensions: 444mm x 85mm x 305mm (WxHxD)  
Weight: 9.0Kg

Please note, the information given in this document is correct at the time of print. Small production changes in the course of improvement through our ongoing research and development policy may arise. If clarification of any point is required please refer to your local authorised IsoTek dealer or visit [www.isoteksystems.com](http://www.isoteksystems.com) where you can download the very latest information.



## F. Considerations

### Product examples

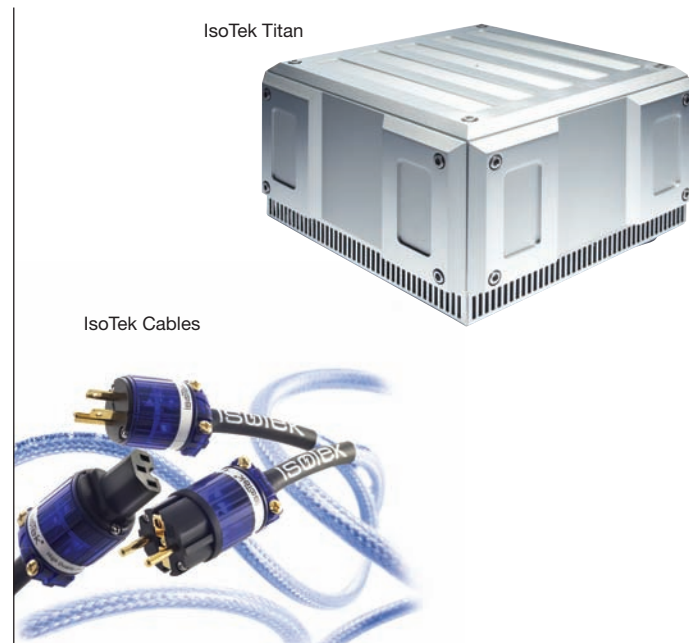

#### Cabling

We strongly recommend that a good quality mains cable is used and this cable is consistent throughout your system. Look for a cable with good conductors, for example OFC (oxygen free copper). This cable should also have a high degree of shielding from RFI. Outside of the UK it is not uncommon for cables of 6Amps current capability to be connected to a 20Amp outlet. In practice this seems to be a safe arrangement. However we strongly recommend a cable of the full 20Amps carrying capability be used, with a minimum 1.5mm squared.

#### Third party products

IsoTek produce their own cable in standard 1.5M lengths. All cables feature high quality connectors, OFC conductors and fully earth shielded. This removes any chance of RFI entering the cable. A number of versions are available: Premire, Premium and Elite as well as higher current Optimum and Extreme. IsoTek 24ct high grade connectors are used in the Elite, Optimum designs these can also be purchased individually.

Our GII range of products work well with all third party equipment including varying cable technologies. If 'off-the-shelf' mains cables are used we recommend the use of Ferrite rings to reduce RFI. We also recommend the use of contact conditioners, for example Blue Horizon's Clean-IT ([www.bluehorizonideas.com](http://www.bluehorizonideas.com)). Isolation devices, feet and cones may also be used. We recommend Clearlight Audio RDC products which we use on our higher end products, for example, Titan.

#### Upgrades

It is possible to increase the performance of the Aquarius through ideal location and product placement, the use of isolation devices and contact conditioners for example. The Aquarius can also be used to run front-end only equipment with one of our dedicated power amplifier products. For example, the introduction of a Titan for that specific purpose. Full details can be found from your local authorised IsoTek dealer or on our web site [www.isoteksystems.com](http://www.isoteksystems.com)

September 2009

## G. Warranty

Please complete & send

As part of our on-going commitment to the highest standards of customer service, IsoTek offers you the opportunity to extend the standard 2 year product warranty to 3 years, free of charge. Simply visit:

**[www.isoteksystems.com/register](http://www.isoteksystems.com/register)**

And follow the on screen instructions. This service will automatically update your details and give confirmation of your registration via email within 24 hours.

IsoTek will not share your personal details with any third parties without your permission.

If you do not have internet access then please forward a copy of your invoice, together with the product serial number and your address to our UK office:

IsoTek Systems,  
4 Mozzetta,  
Kings Head Yard,  
Winchester,  
SO23 9HN  
England.